

SIKORSKY® UH-60 BLACK HAWK®
MMS461

360°
view



It is highly recommended that you visit
www.metal-earth.com/360/mms461
to see the completed model before assembling your own

TO CREATE THE BEST CONNECTIONS

B-19

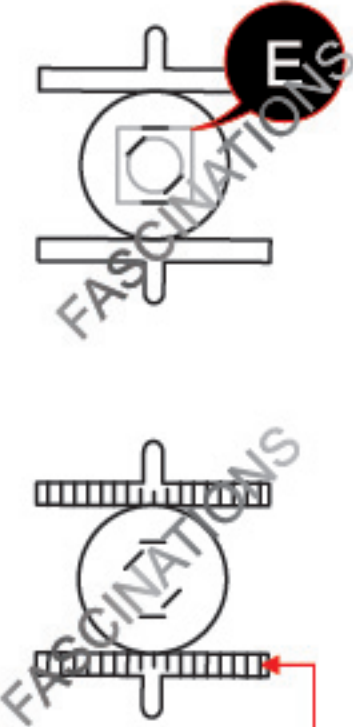

Consider these engraved stripes as supporting features for the bend

A-55

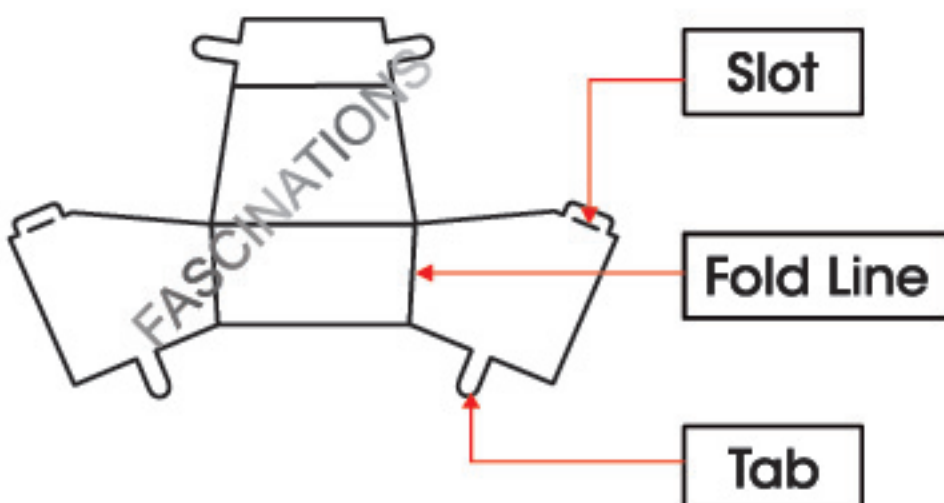

Legends:

E Engraved/ Color side

NE Non - engraved/ Silver side

Attention point

Insert tab and bend 90 degrees

Insert tab and twist 90 degrees

Assembly tip:

If needed, slightly twist tabs to hold parts together then untwist and bend them down for a nice finish.



In order to avoid possible injury from sharp edges, please carefully discard the metal sheets after parts have been removed.

Recommended tools:

- Wire cutters: helpful for taking parts from the metal sheets.



- Tweezers or needle nose pliers: helpful for folding parts, bending and twisting tabs.

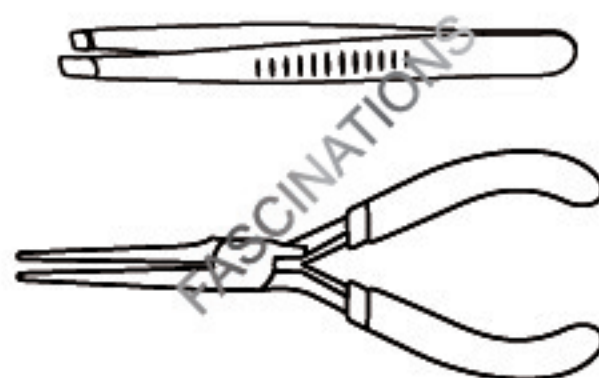

METAL SHEETS

Parts with same color are duplicates

A

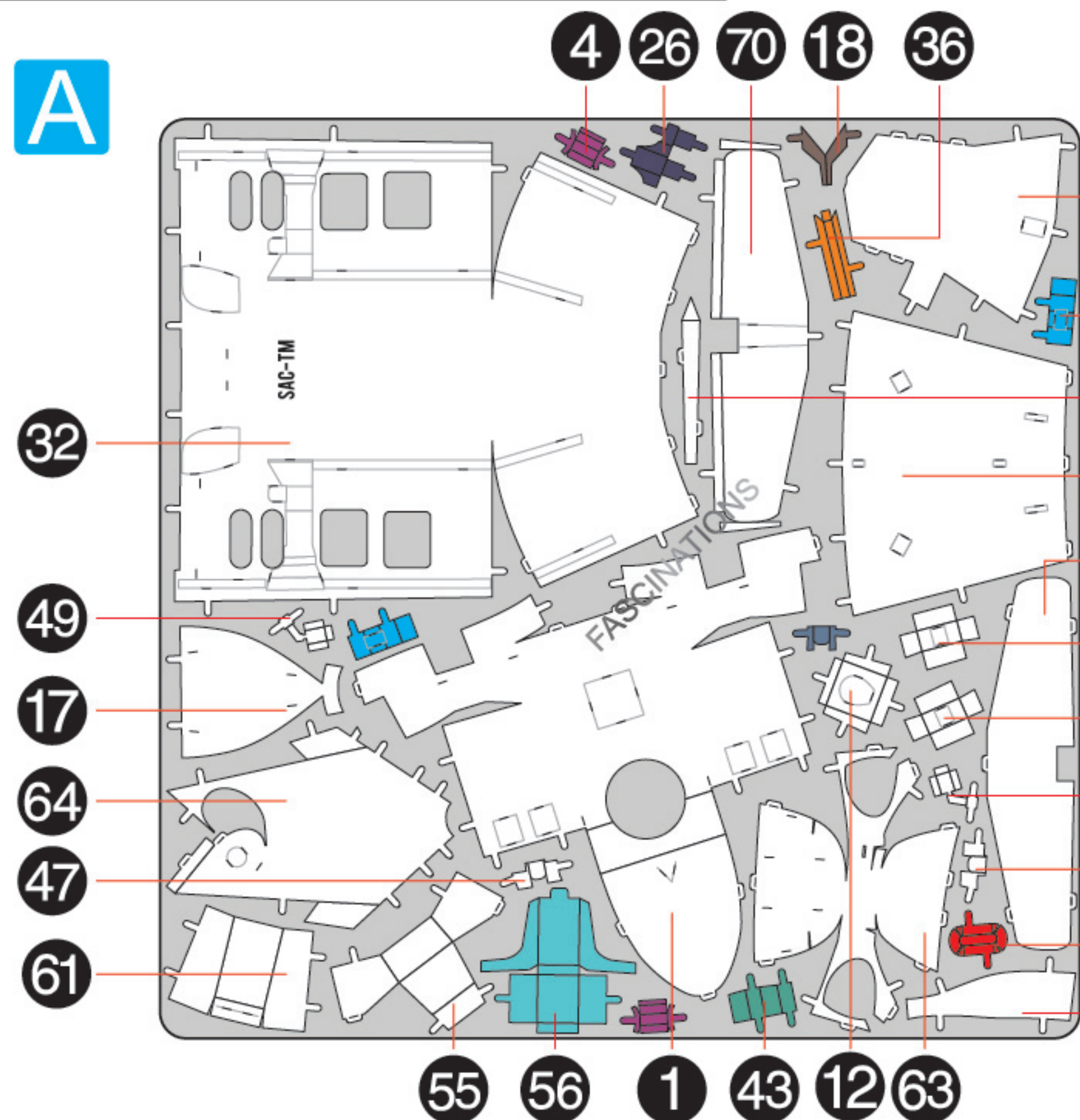

B

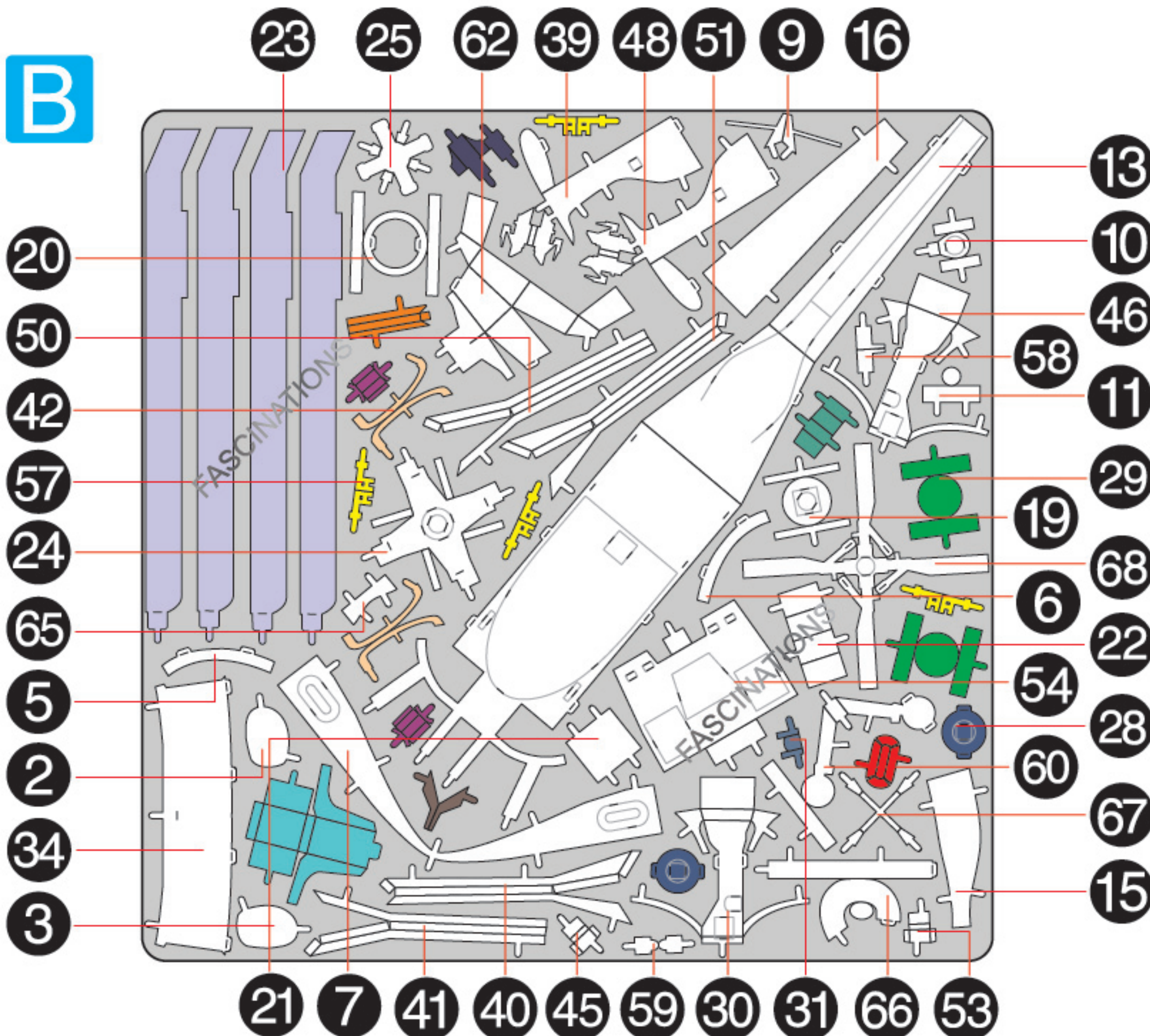

Go to www.metal-earth.com/360/mms461 to see the zoomable PDF version of this instruction sheet

ASSEMBLY FLOW CHART

Step 1

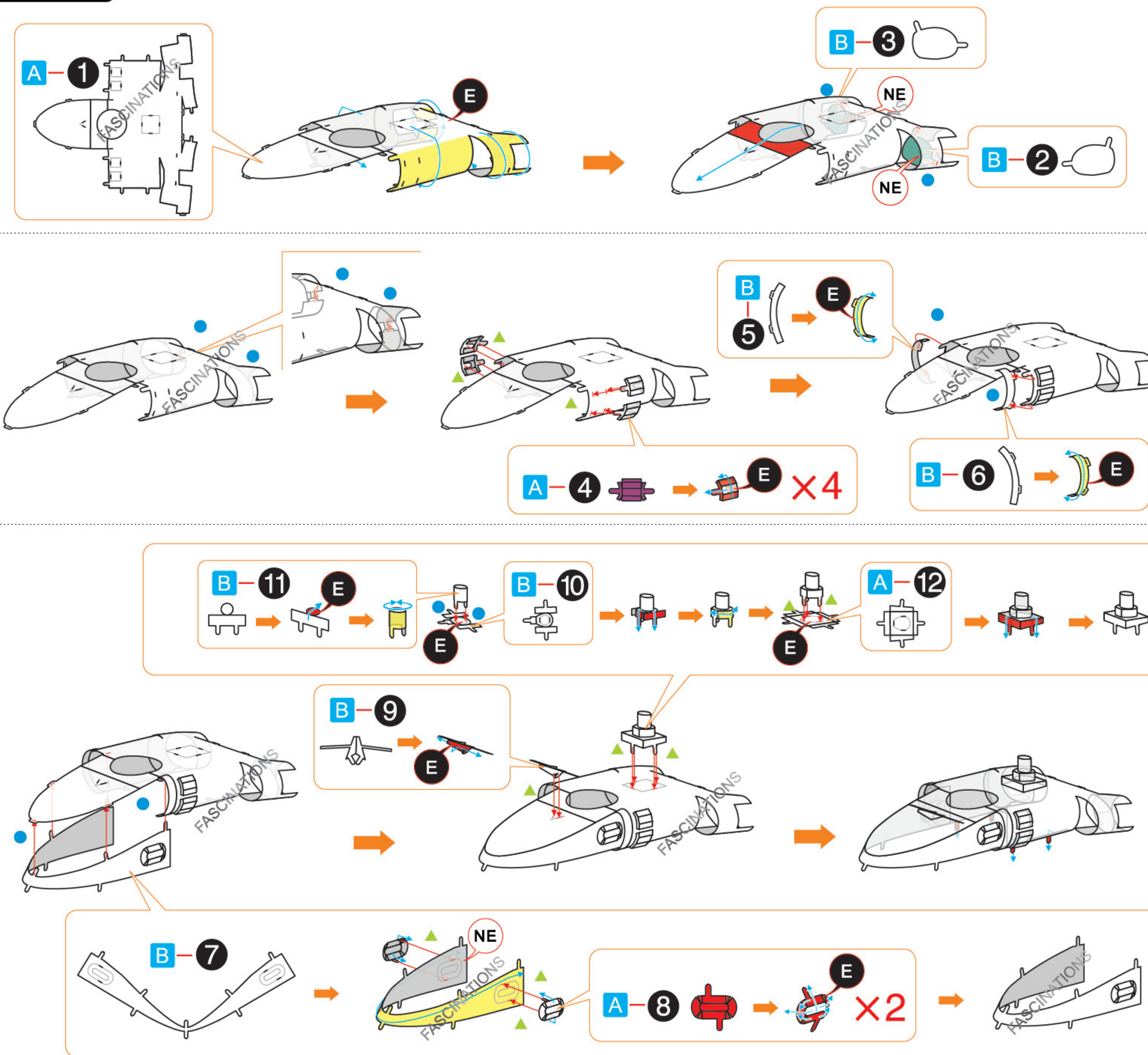

Step 2

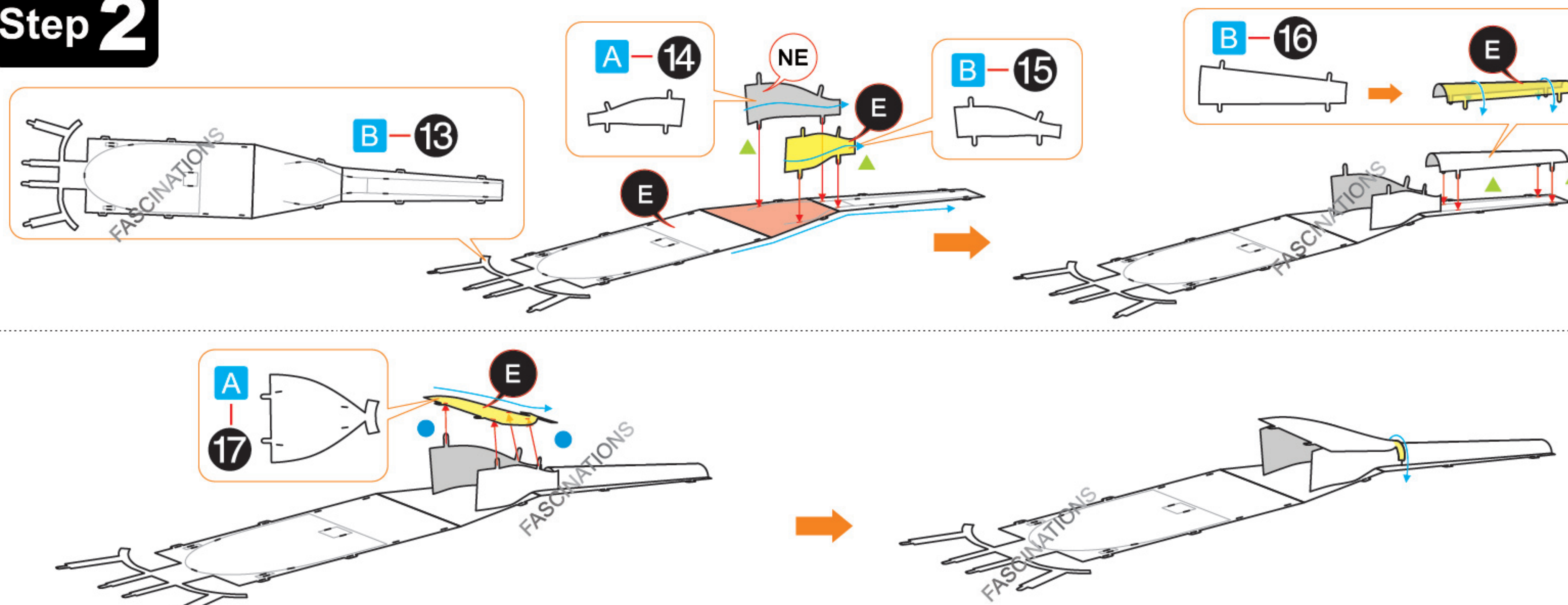

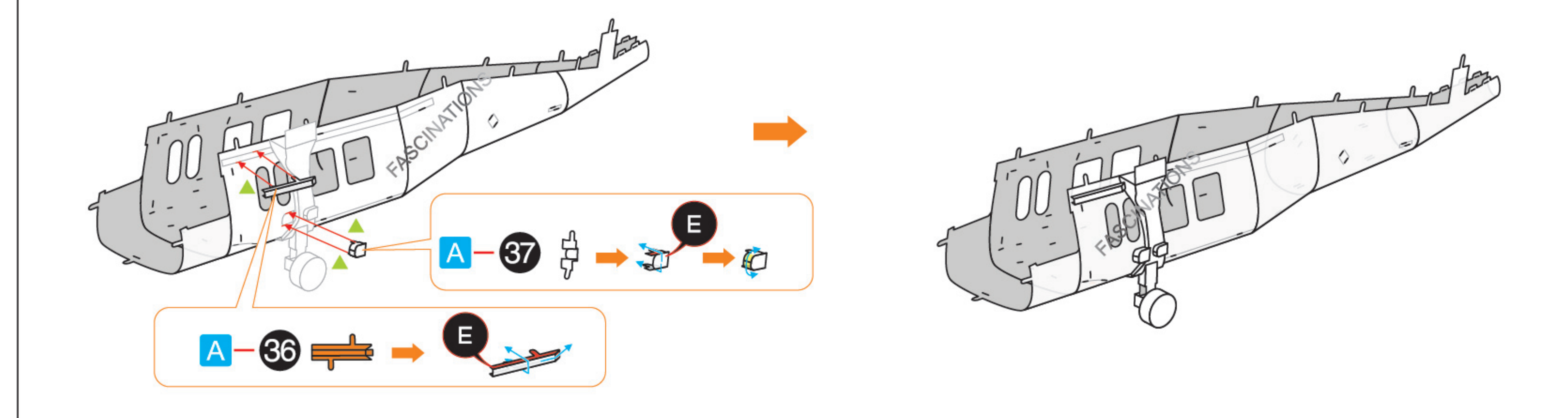
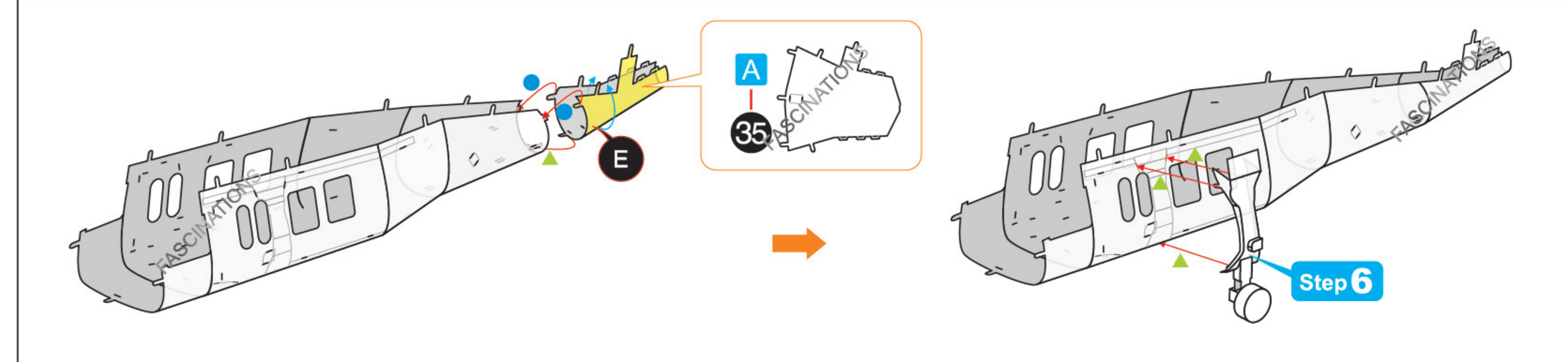
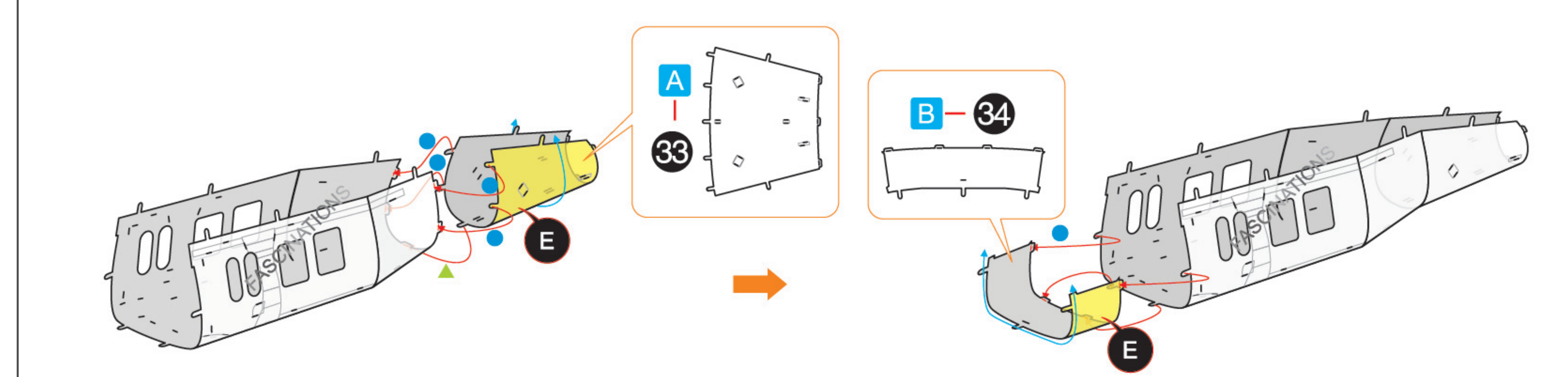
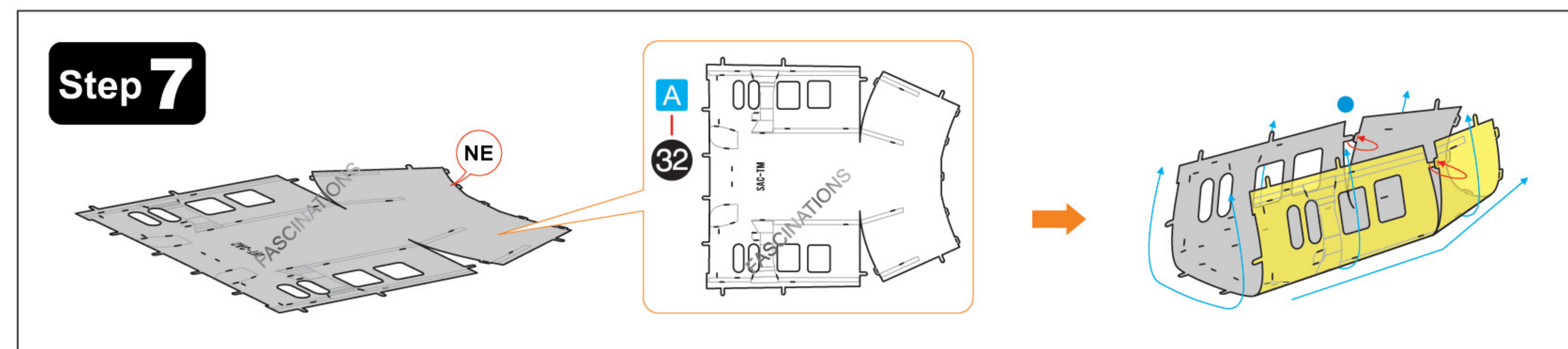
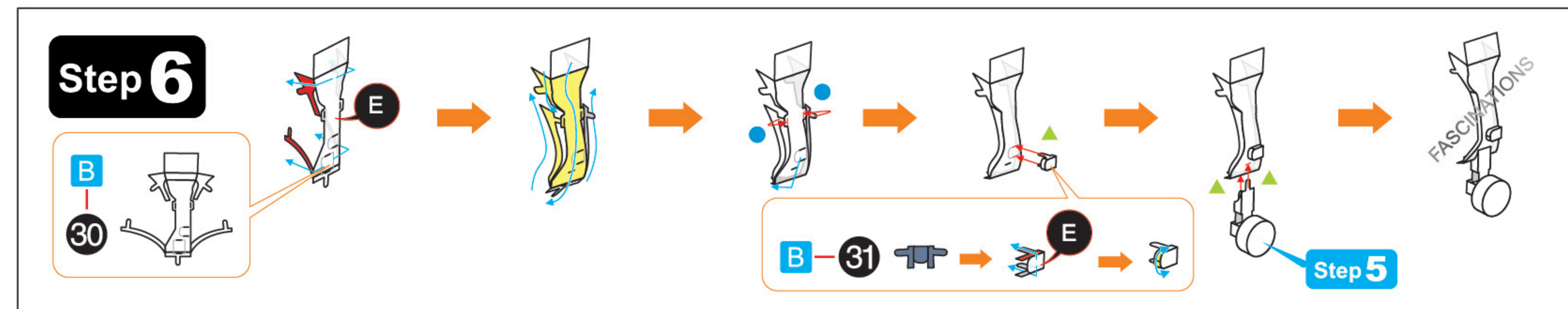
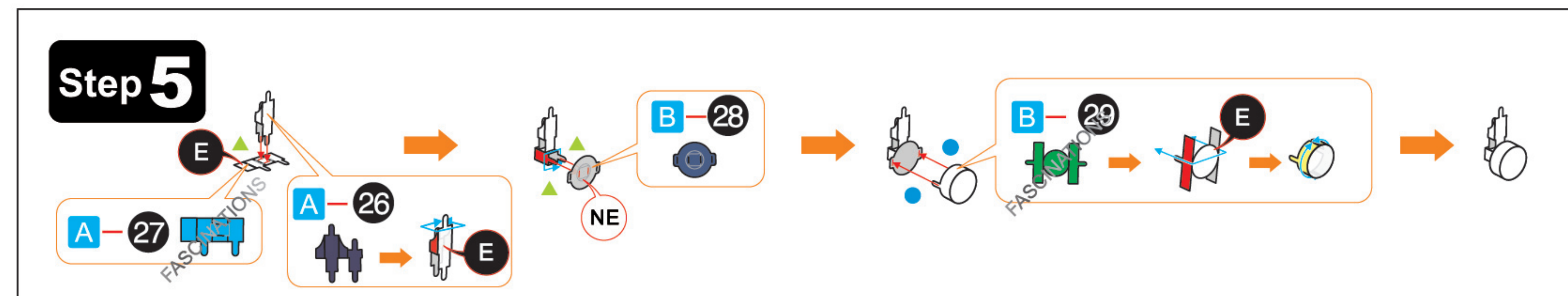
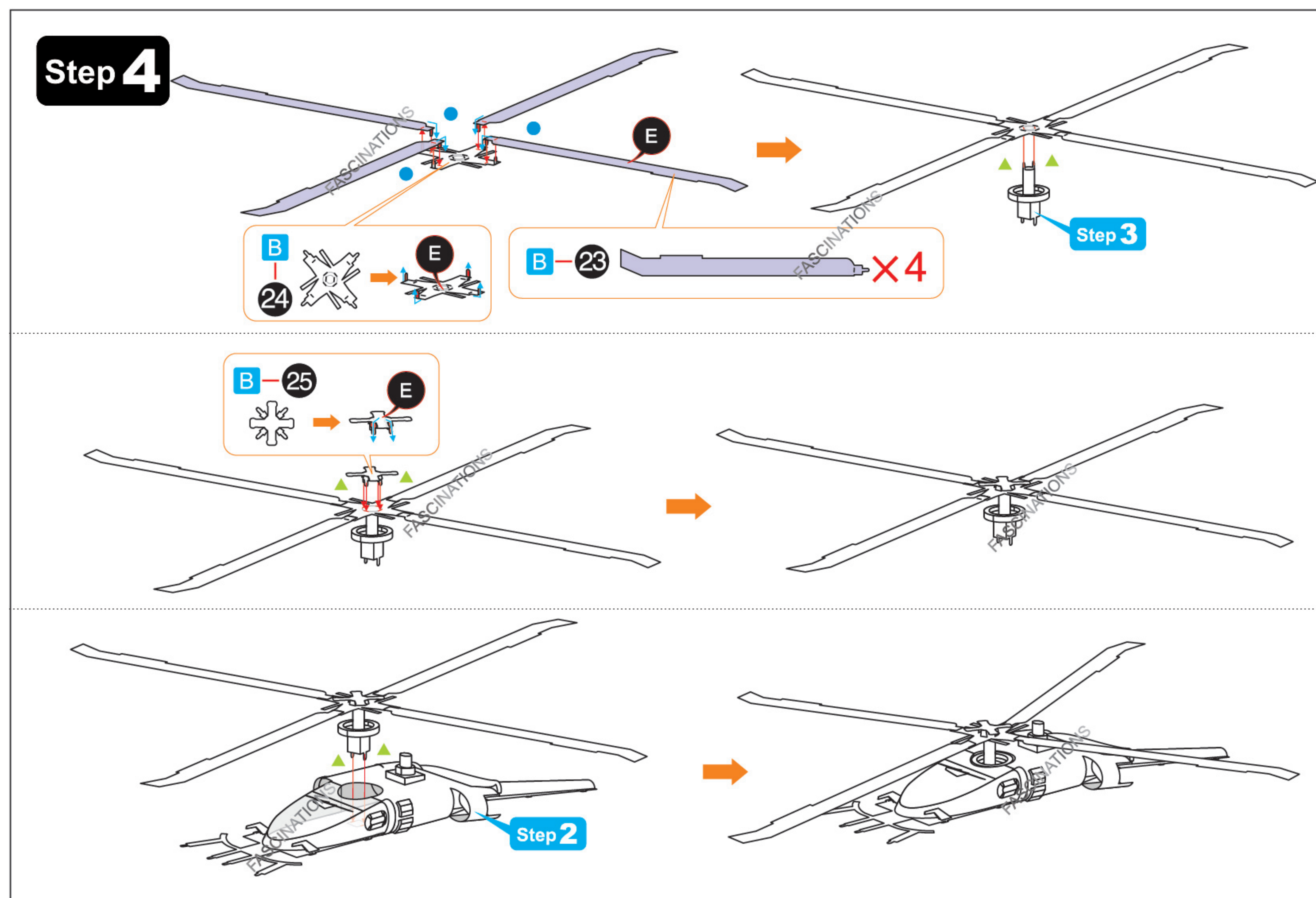
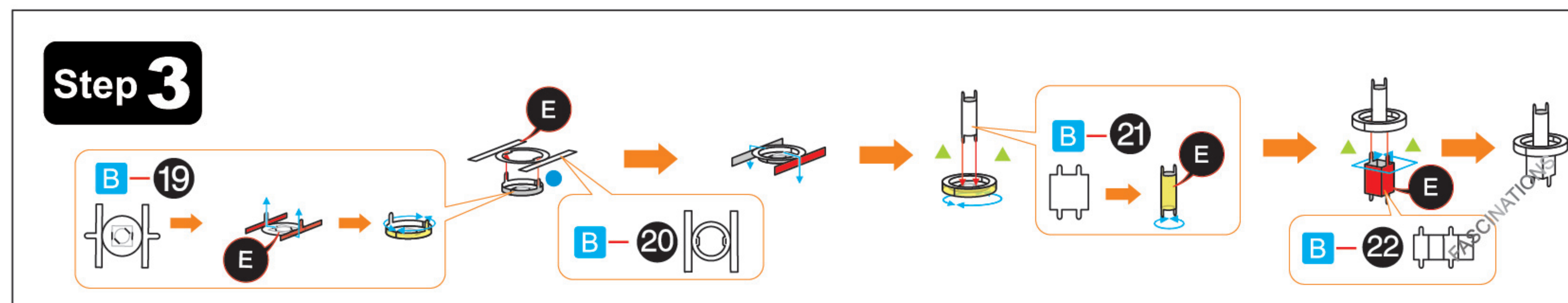
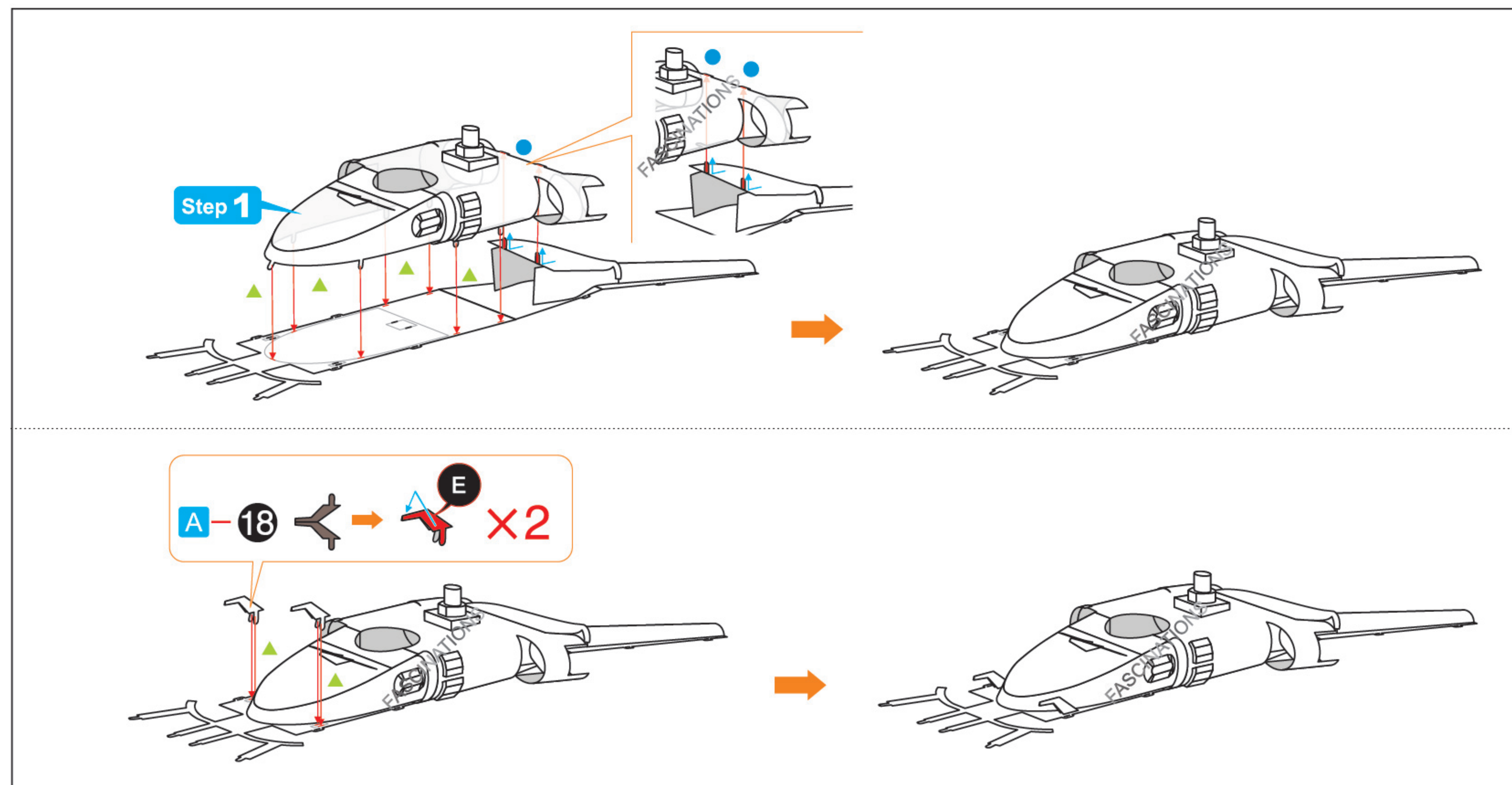

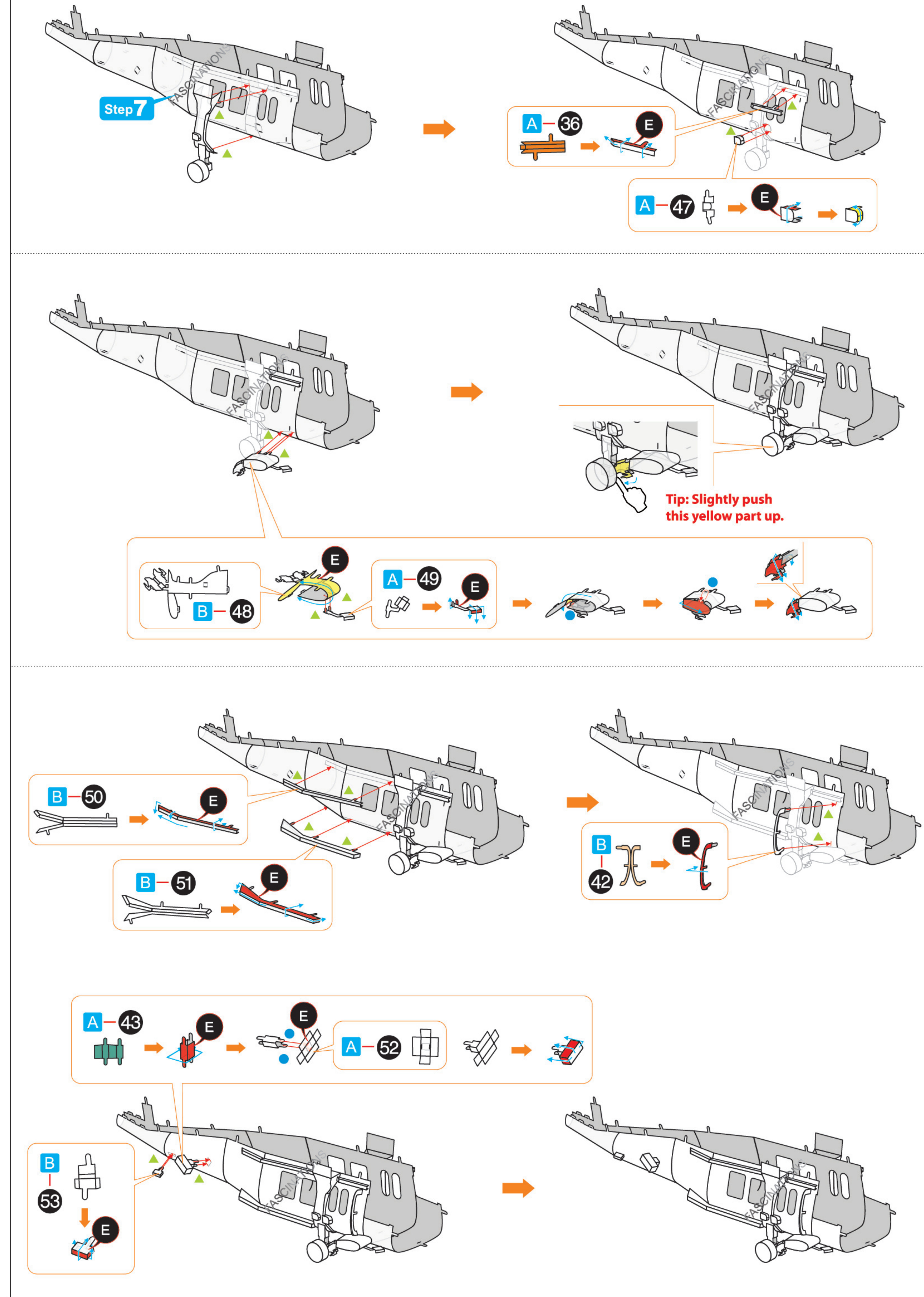
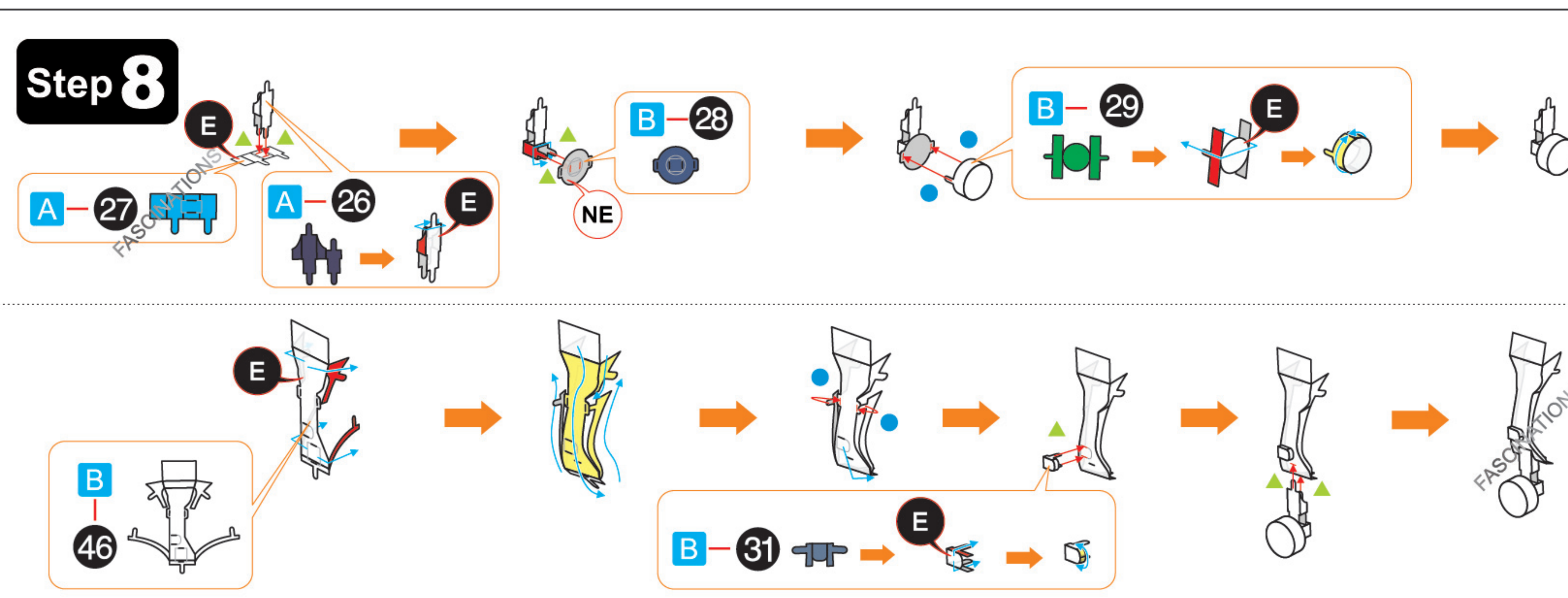
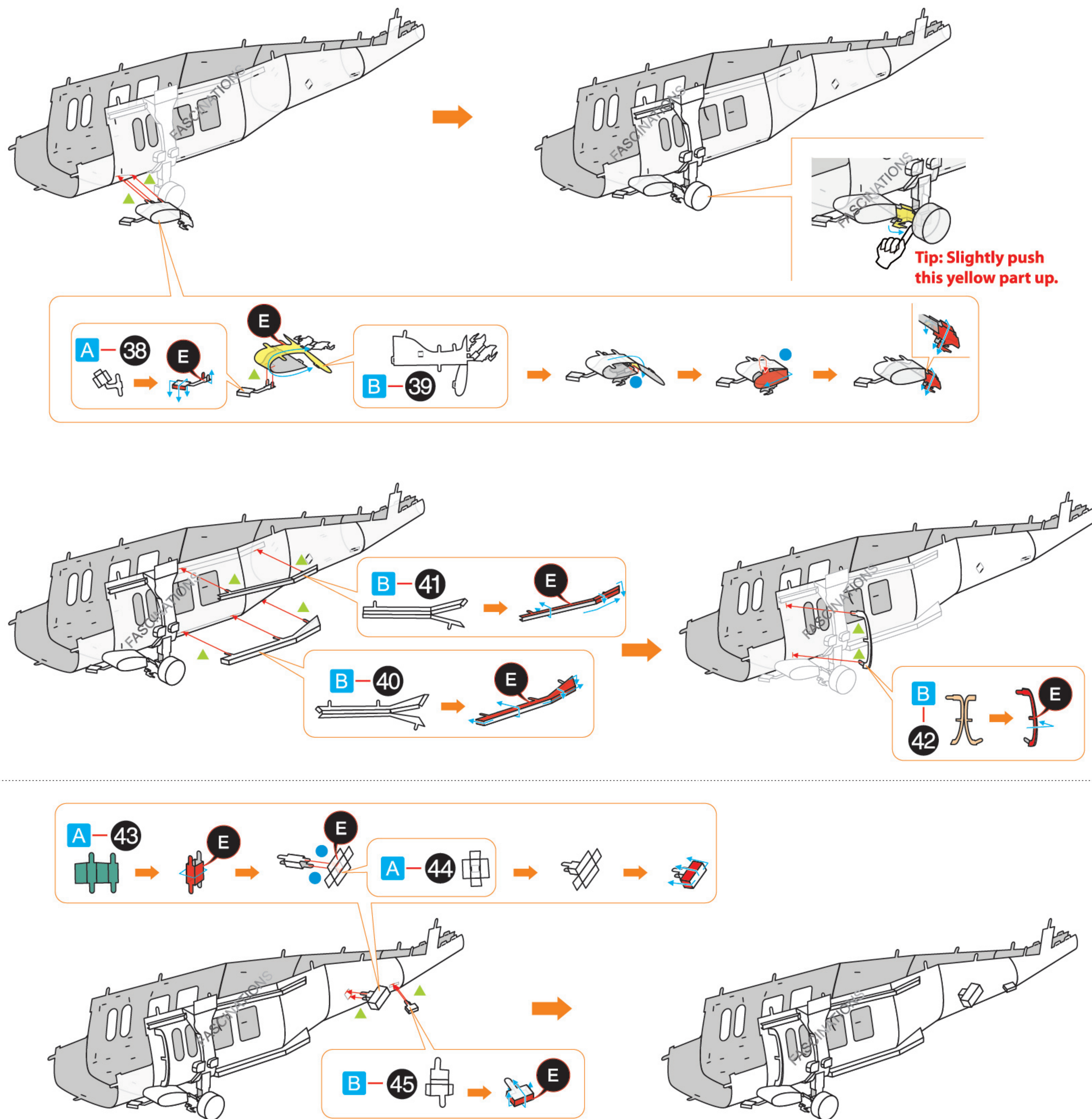

Step 9

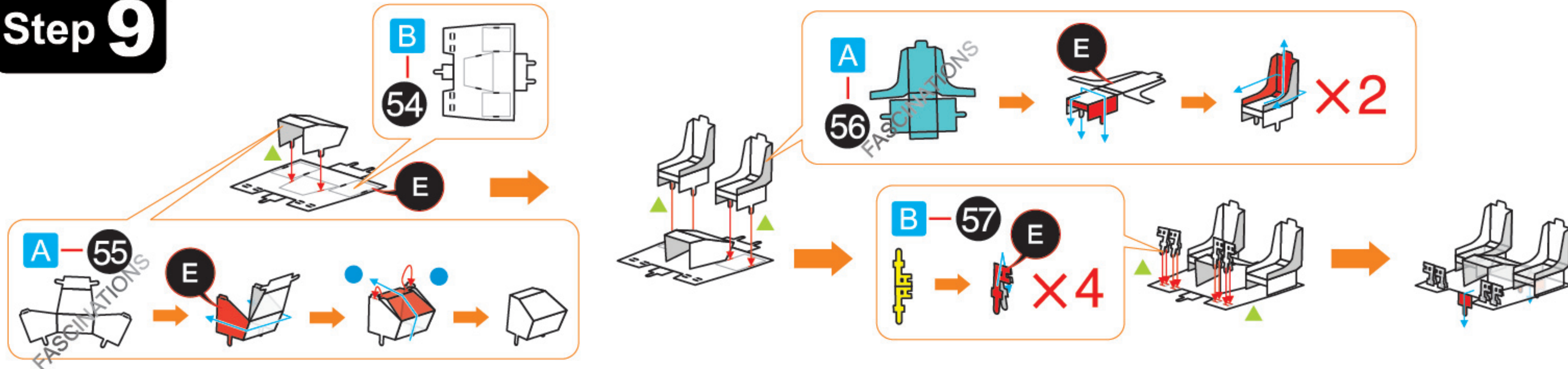

Step 10

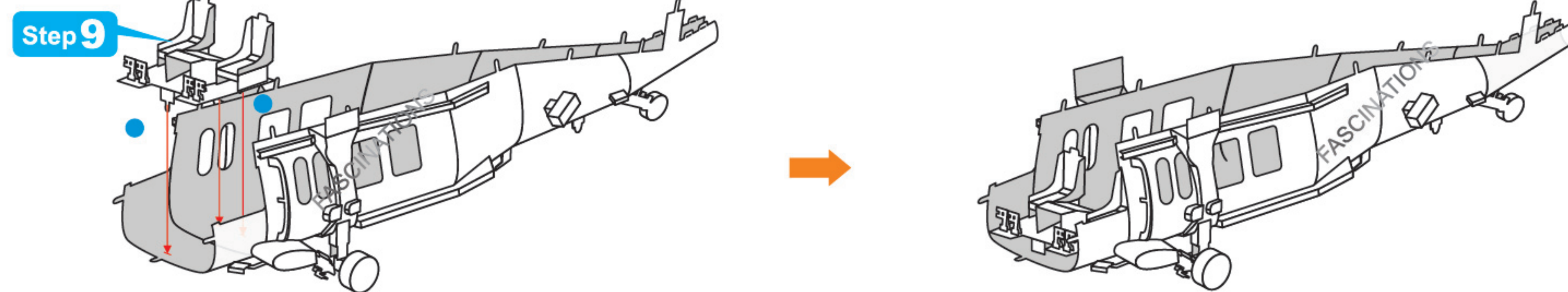
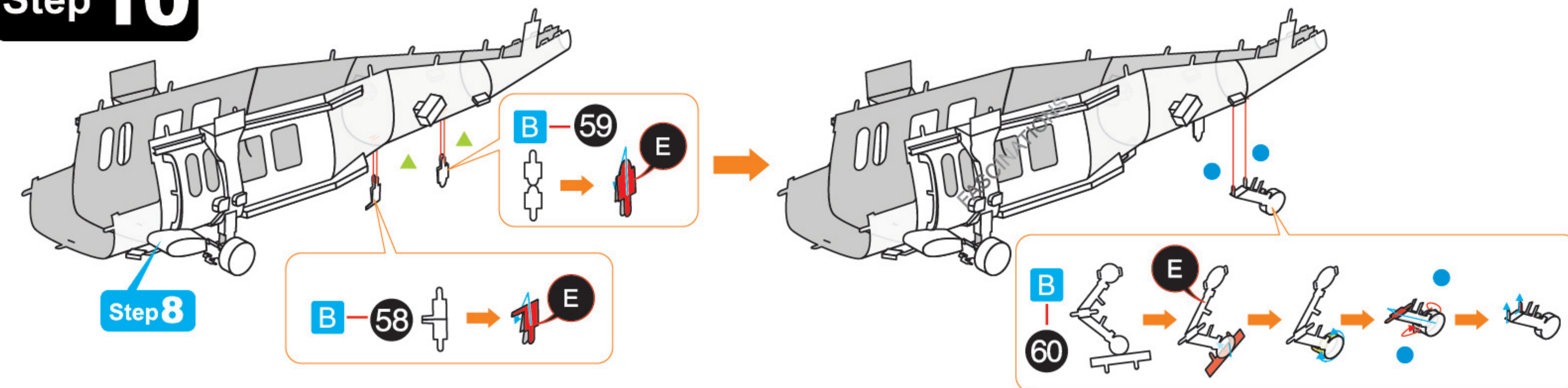

Step 11

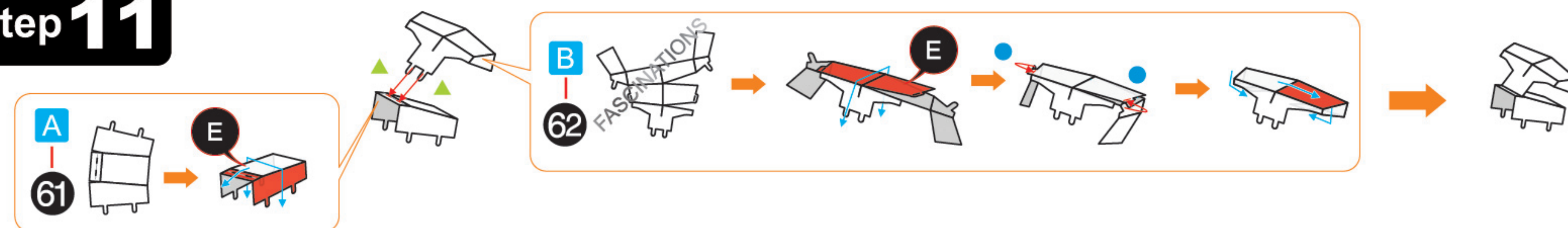

Step 12

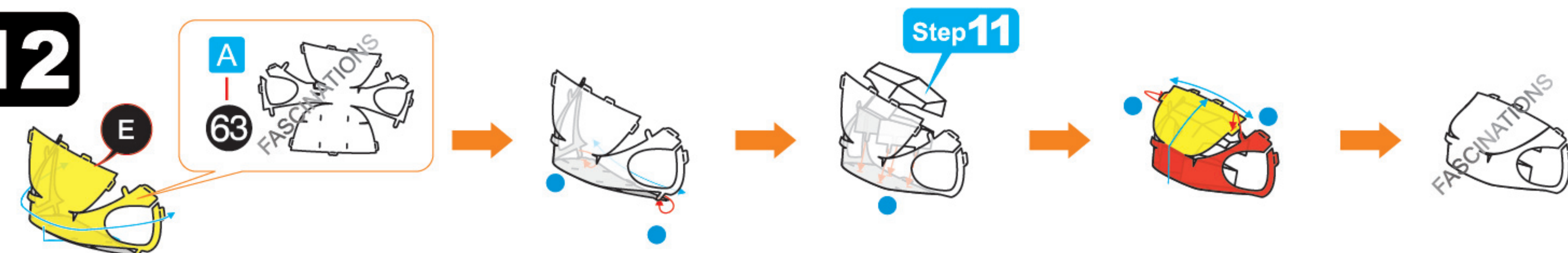

Step 13

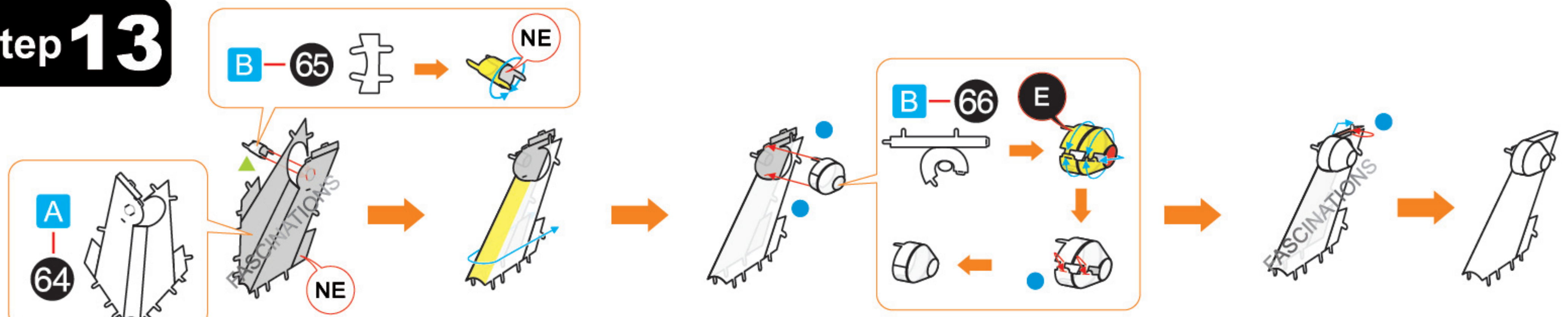

Step 14

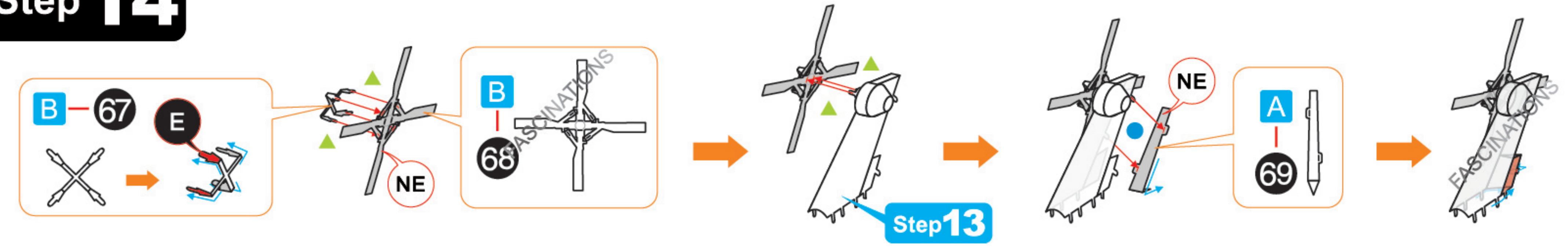

Step 15

